

卫生阀 · 海吉雅

HGA

海吉雅流体设备(昆山)有限公司
HYGEIA FLUID EQUIPMENT (KUNSHAN) CO., LTD.

地址: 江苏省昆山市陆家镇新民路55号
电话: 0512-50153468
传真: 0512-50153458
网址: www.ks-hga.com
邮箱: HGA@vip.163.com

Add: No. 55, Xinmin Road, Lujia Town, Kunshan City,
Jiangsu Province
Tel: 0512-50153468
Fax: 0512-50153458
Http://www.ks-hga.com
E-mail: HGA@vip.163.com



设计印刷 品质品牌 13819714984

诚招全国代理商，加盟海吉雅共创辉煌！
National Recruitment agents, joined HYGEIA valve to create brilliant!

© 海吉雅(HYGEIA) 版权所有
采用生态纸印刷 Adopt ecological paper to print

HGA

COMPANY PROFILE

企业简介

海吉雅流体设备（昆山）有限公司位于江苏省昆山市陆家经济开发区，是从事食品、制药等领域卫生级阀门的研发、制造与销售为主的企业。主要产品有：卫生级截止阀、调节阀、隔膜阀、防混阀、电动阀、单向阀、手动及自动阀门等，也可以根据客户的要求设计制作。凭借丰富的经验、一流的设备、精湛的技术以及引进国外先进技术开发出的系列卫生阀，充分满足客户和市场需求。我们将不断创新为广大客户提供更高、更好、更安全的产品及更优质的服务。我们的宗旨：以质量求生存，靠信誉求发展。

全员将团结一致、共同携手，为实现发展成为中国和世界知名品牌的宏伟目标而不懈努力！竭诚欢迎国内外朋友的合作，共创辉煌！

Located in Lujia Economic Development Zone, Kunshan City, Jiangsu Province, HYGEIA Fluid Equipment (Kunshan) Co., Ltd. is an enterprise specialized in researching, developing, manufacturing and selling sanitary valves for such industries as food, medicine and etc. Our main products include: sanitary globe valves, control valves, diaphragm valves, mixing-proof valves, electric valves, check valves, manual and automatic valves, etc. We can also design and manufacture products according to customer requirements. Our sanitary valves of various series developed with our rich experience, first-class equipment, exquisite technology as well as advanced technology introduced from abroad fully meet customer and market demands. We will innovate continuously to provide customers with more excellent, better and safer products and services of higher quality. Our principle is to survive by quality and develop by reputation.

All personnel will unite as one and join hands to make endless efforts for the realization of the grand goal of building China's and world's famous brands. We sincerely expect to establish cooperation relationships with friends from home and abroad to create mutual resplendence.



PRODUCTION AND EQUIPMENT

生产与装备

公司拥有高精度的数控机床及进口加工中心等领先的高新设备，并聚集了一批科研精英及高级技工队伍，充分利用新技术、新工艺、新材料，以保证产品的稳定性和可靠性，从而创造出至臻的产品品质。通过采用先进的、科学化的制造方法及娴熟的制造技术，有效缩短了产品的制造周期，提高了运营效率，有效保证了用户的个性化需求。积极创新、精益求精，是海吉雅永恒追求。

Our company has advanced high-tech equipment such as high-precision CNC machine tools and imported machining centers, and moreover, we gather scientific research elites and senior technician team, so as to make full use of new technologies, new techniques and new materials to guarantee stability and reliability of products and create perfect product quality. By adopting advanced, scientific manufacturing methods and mature manufacturing technologies, we have effectively shortened product manufacturing period, enhanced operation efficiency and efficiently ensured individualized demands of customers. HYGEIA is always in pursuit of innovating actively and keeping improving.

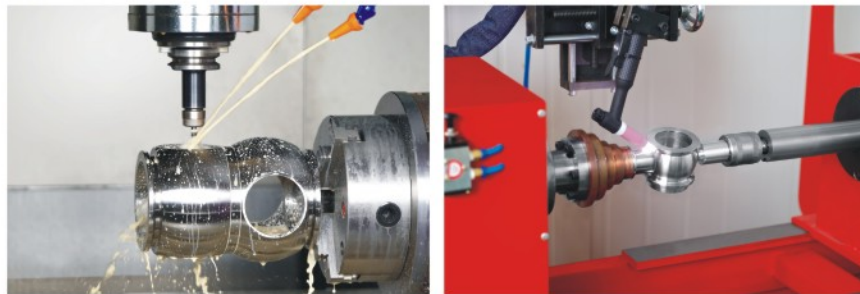

INSPECTION, ASSEMBLY AND TEST

检测 组装 测试

海吉雅对每一个产品都进行严格的检测。检验员高度负责的用心融于每一个部件中，加上最先进的检测设备和严格的科学化管理，使每一个产品的成品经得起顾客的精心挑选。海吉雅人庄严承诺让每一个生产的产品都能达到出厂标准，这是海吉雅产品得以畅销的秘诀所在。



HYGEIA carries out strict inspection of every product. The highly responsible inspectors concentrate on every part and with the most advanced inspection equipment and strict scientific management, every piece of finished product is capable of standing up under customers' careful selection. HYGEIA personnel make the promise that every product reaches the standard before leaving the factory. This is the reason why HYGEIA products are so popular.

MARKETING NETWORK

营销网络



今天的海吉雅，专业精英荟萃、技术力量雄厚。今天的海吉雅，正向着具有强大技术创新能力和品牌实力的行业龙头企业挺进。将民族品牌推向世界，成为国际化品牌，这是一条漫长而艰辛的道路，但海吉雅坚信，只要努力，梦想不再遥远！

Today's HYGEIA gathers professional elites with powerful technical strength. Today's HYGEIA is striding towards the goal of becoming a leading enterprise in the industry with powerful technical innovation capability and brand strength. We will take a long and arduous road to push national brands towards the world and develop them into international brands, but we are fully convinced that the dream is not very far as long as we work hard.



VALVE APPLICATIONS

阀门应用范围

海吉雅是一家集科研、设计、开发、生产、安装、售后服务、咨询于一体的专业生产流体设备及配件的科技型企业，其多样化和高品质的产品，广泛应用于乳品、饮料、啤酒、白酒、医疗、调味品、日化、水处理等领域。

Integrating scientific research, design, development, production, installation, after-sales service and consultation, HYGEIA is a technology-oriented enterprise specialized in producing fluid equipment and fittings. Our diversified and high quality products are widely applied in such industries as dairy products, beverage, beer, alcohol, medicine, condiments, daily chemicals, water treatment, etc.



PRODUCTS CATALOGUE

产品目录



SANITARY VALVE • HYGEIA

HYGEIA FLUID
EQUIPMENT (KUNSHAN) CO., LTD.

控制器 CONTROLLER	15
特征描述 FEATURE DESCRIPTION	17
截止阀/换向阀 GLOBE VALVE/REVERSING VALVE	19
流量调节阀 FLOW CONTROL VALVE	23
无菌分割隔膜阀 ASEPTIC SEGMENTED DIAPHRAGM VALVE	26
防混阀 MIXING-PROOF VALVE	30
电动流量调节阀 ELECTRIC FLOW CONTROL VALVE	33
手动阀 MANUAL VALVE	35
单向阀 CHECK VALVE	38
卫生级配管部件 SANITARY PIPE FITTINGS	40

凭借丰富的经验和 引进国外先进技术而开发出的卫生阀系列

Sanitary valve series developed with rich experience and advanced technology introduced from abroad



标准规格	STANDARD SPECIFICATION
● 配件规格 Fittings specification	管夹式, 焊接式(符合ISO规格) Pipe clamp type, welding type (conforming to ISO standard)
● 口径 Size	25, 38, 50, 64, 76, 100mm
● 接液部材质 Material of liquid-contacting part	SUS304 (SUS316)
● 垫圈, 封条材质 Material of gasket and seal strip	EPDM (NBR, H-NBR, PTFE, 氟橡胶Fluorine rubber)
● 常用液温度范围 Common liquid temperature range	-20°C ~ 145°C
● 表面加工 Surface machining	内外面喷砂研磨 (内面#400 外面#300 布擦研磨) (内面#400 布擦研磨, 外面喷砂研磨) (内外面电解研磨) Interior and exterior surface sand blasting and grinding (interior surface #400 exterior surface #300 grinding by cloth) (interior surface #400 grinding by cloth, exterior surface sand blasting and grinding) (Interior and exterior surface electrolysis grinding)
● 最高使用压力 Maximum working pressure	1.0MPa
● 供给空气压 Air supply pressure	0.4 ~ 0.5MPa

控制器

CONTROLLER

外观

- ▶ 控制器独特的外部造型，顶部透明的天窗设计，根据其透出的LED灯颜色，可直观判断阀的开闭状态。
- ▶ LOGO处采用镶嵌式结构，LOGO两种不同的颜色，代表着阀出厂的开闭状态。
- ▶ 内部控制单元磁感应部件和电磁阀都是采用国外知名品牌，有很好的质量保证。
- ▶ 电路板控制单元在国外品牌的成熟工艺的基础上开发而成。具有功能强大、性能稳定、操作简单易懂。

Appearance

- ▶ The controller has unique outer shape and top transparent skylight design. The opening and closing status of the valve can be judged directly according to the color transmitted from the LED light.
- ▶ An embedding structure is adopted at the LOGO. Two different colors are used on the LOGO, representing the opening and closing status of the valve.
- ▶ The internal control unit magnetic sensing part and electromagnetic valve are products of internationally famous brands, providing reliable quality guarantee.
- ▶ The circuit board control unit is developed on the basis of mature processes of internationally famous brands. It has such features as powerful functions, stable performance and easy operation.

性能

- ▶ 根据预留的数据接口，中央控制柜可以很好的控制电磁阀的开闭，从而达到控制阀的开闭。
- ▶ 控制单元中根据阀的开闭提供反馈信号，以显示阀的工作状态。
- ▶ LED灯光的颜色是代表着阀的工作状态(绿色是闭合状，蓝色是打开状)。
- ▶ 增加电路模块，提供4-20mA的电流就可以实现阀的比例控制，实现任意开度。

安全、坚固

控制器外壳，具有抗冲击性，防紫外辐射，控制器有很好的防水性，在一些恶劣环境中有很好的防护作用。

维护

控制器采用模块化设计，其内部结构简单，零件少，维护保养简单易懂。

Performance

- ▶ According to the reserved data ports, the central control cabinet can well control the opening and closing of electromagnetic valves so as to control the opening and closing of control valves.
- ▶ According to the opening and closing of the valve, the control unit will provide feedback signals to display the working status of the valve.
- ▶ The colors of the LED light represent the working status of the valve. (Green means closing status and blue means opening status.)
- ▶ When the circuit module is added to provide 4-20mA current, proportional control of valves can be achieved to realize any opening.

Safe and solid

The controller housing has good anti-impact performance and ultraviolet resistance. The controller has excellent water resistance, playing a good protection function in some severe conditions.

Maintenance

The controller adopts modular design, featured by simple inner structure, few parts and easy maintenance and servicing.



特征描述

FEATURE DESCRIPTION

模块化控制器 :

- ▶ 防水性能: IP66
- ▶ 控制器外壳材质: ABS
- ▶ 磁感应开关: 最多3个
- ▶ 电磁阀数量: 最大3台

Modular controller, equipped with:

- ▶ Waterproof performance: IP66
- ▶ Controller housing material: ABS
- ▶ Magnetic sensing switch: at most three
- ▶ Electromagnetic valve quantity: at most three

磁感应开关与电磁阀

采用世界知名品牌, 以确保控制器的安全稳定运行, 提高产品的寿命

Magnetic sensing switch and electromagnetic valve

Products of world famous brands are adopted to ensure safe and reliable running of the controller and prolong product service life.

“海吉雅”品牌标志 “HYGEIA” brand logo

气缸驱动10年功能保证

- ▶ 气缸经焊接成一个整体, 各种规格的气缸允许压力差为0.5u兆帕, 阀芯密封压块的耐久性也随之提高。
- ▶ 气缸的内部结构决定阀的常开常闭。
- ▶ 免维护
- ▶ 不可拆卸

Cylinder driving 10-year function guarantee

- ▶ The cylinder is welded into a whole. The allowable pressure difference between different specifications of cylinders is 0.5u MPa, and the durability of the plug sealing block will increase.
- ▶ The inner structure of cylinder determines normal opening and normal closing of the valve.
- ▶ Free of maintenance
- ▶ Irremovable

阀体设计

- ▶ 阀体内无死区, 清洗可靠。
- ▶ 因阀体内腔高度与接管内径相同, 内腔底面采用锥面设计, 所以不留残液。
- ▶ 阀体采用一体式加工, 且比传统焊接加工具有更好的稳定性、安全性。

Body design

- ▶ There is no dead zone inside the body, the cleaning of which is reliable.
- ▶ As the body cavity height is the same as the connection pipe inside diameter and the cavity bottom face adopts conical face design, there is no residual liquid.
- ▶ Adopting integral machining, the body has better stability and safety than those adopting welding machining.



LED灯

阀常闭常开时显示不同的颜色, 使阀的工作状态便于识别。

LED light

It displays different colors when the valve is normally opened or closed, so as to facilitate the identification of working status of the valve.

空气接头

采用世界知名品牌, 从每一个细节做到完美。

Air connector

By adopting world famous brands, we seek perfection in every detail.

产品编号

Product No.

维护简单

阀体采用卡箍固定, 安装拆卸方便快捷, 便于日后保养。

Simple maintenance

The body is fixed by clamp. The convenient and quick installation and disassembly make future maintenance easy.

阀杆(摩擦部)及轴封

- ▶ 摩擦部使用了PTFE型耐磨材料, 从而提高了其安全性能及耐腐蚀性。
- ▶ 轴封为成型垫圈, 防止沟槽内有残留。
- ▶ 垫片材质: EPDM(HNBR,PTFE)

Stem (friction part) and shaft seal

- ▶ The friction part is made of PTFE anti-wear materials, which improve its safety and corrosion resistance.
- ▶ The shaft seal is formed gasket, which avoids residuals in the groove.
- ▶ Gasket material: EPDM (HNBR, PTFE)



阀杆与密封垫圈

安装密封垫圈不需要特殊工具, 易保养。
阀杆材质采用: 316
密封垫圈全部采用日本和欧洲进口, 通过FDA认证和3A认证, 满足食品安全的要求。

Stem and sealing gasket

With easy maintenance, the sealing gasket does not need any special tools.
Stem material: 316
The sealing gaskets are imported from Japan and Europe. Certified to FDA and 3A, they meet the requirements for food safety.

正动作和逆动作

Direct acting and reverse acting

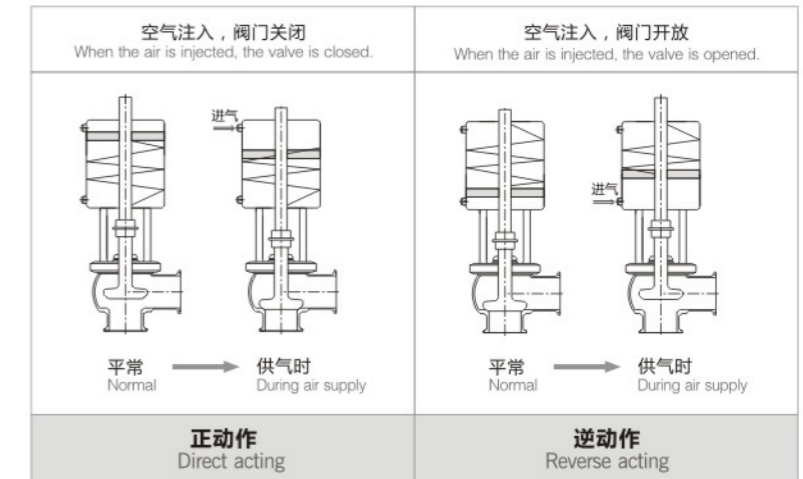

GLOBE VALVE/ REVERSING VALVE

截止阀/换向阀

新型卫生截止/转换阀门，具有更多的安全性，洁净性，耐久性及美观性。

拥有开放式的支架，将气缸与阀体分开，可以直接对轴密封进行检查。这一设计使阀的传动装置和阀体部分分离，防止了从阀体到气动装置的热传递。

阀门“常关闭”与“常开启”功能可瞬间转换。

球形阀体具有理想的流动性，清洗性，对物料的处理更温和。

采用卡扣式的连接，使安装和维护保养都非常方便。

The new type sanitary globe valve/reversing valve is featured by more safety, cleanliness, durability and beautiful appearance.

It has an open yoke that separates the cylinder from the body so as to directly carry out inspection of the shaft seal. This design enables the valve actuator to be separable from the body and avoids heat transfer from the body to pneumatic actuator.

The valve "normal closing" and "normal opening" functions can switch instantly.

With ideal flowability and cleanliness, the spherical body treats materials more gently.

It adopts snap-in type connection to make installation, maintenance and servicing very convenient.



换向阀

Reversing valve

■ 特征 Features

- 简单独特的构造，分解，检查容易
- 各项零件通用，可以有多种多样的组装方式。
- 阀杆垫圈的更换无需使用专用工具，简单方便。
- Simple and unique construction, easy disassembly for inspection
- All parts are interchangeable. There are diversified assembly ways.
- The replacement of stem gaskets is simple and convenient without the need of using any special tools.

■ 气动马达 Pneumatic motor

- 气动马达采用了管理容易的一体型构造，反转组装就能够变更运转方式。
- 气动马达全部使用Spring Return方式，发生停电等异常的情况时，也能够正确的全开全闭。
- 监视气动马达顶部的识别帽，从远处也能够简单的确认阀的运转方式和状态。
- The pneumatic motor adopts an integral structure that is easy to manage. The running mode can be changed through reversing the assembly.
- The pneumatic motor adopts Spring Return mode. In case of power cut or other abnormal situations, it can correctly carry out full opening and full closing.
- The valve running mode and status can be simply identified from a remote distance through monitoring the identification nozzle at the top of the pneumatic motor.



气动马达耐压 : 1.0MPa
 气动马达空气消费量 : 1.5NL~2.0NL/冲程
 气动马达材质 : SUS304
 气动马达表面加工 : 喷砂研磨加工

Pneumatic motor pressure withstanding : 1.0MPa
 Pneumatic motor air consumption : 1.5NL~2.0NL/stroke
 Pneumatic motor material : SUS304
 Pneumatic motor surface machining : sand blasting and grinding

■ 型号 Model

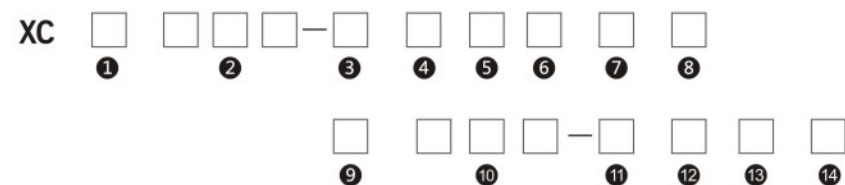

1 接口 Connection

K	管夹 Pipe clamp
N	螺纹 Thread
W	焊接 Welding

2 口径 Size

025	25mm
038	38mm
050	50mm
064	64mm
076	76mm
100	100mm

3 形式 Form

A	自动 Automatic
H	手动 Manual
M	电动 Electric

4 阀体形状 Body shape

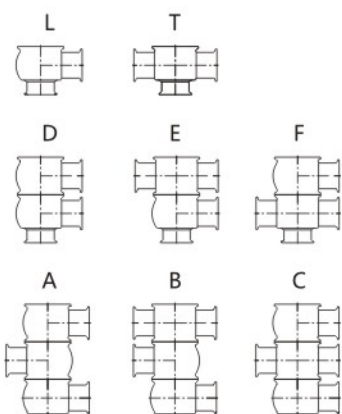

5 轴封式样 Shaft seal pattern

0	标准 (密封圈) Standard (seal ring)
---	-------------------------------

6 气缸式样 Cylinder pattern

N	没有 No
1	标准 standard
4	WSP马达 WSP motor
5	电控控制 Electric control

7 气缸动作 Cylinder action

N	无 No
1	正作用单压/电动正作用(DC24V) Direct acting single pressure/electric direct acting (DC24V)
2	正作用双压 Direct acting double pressure
3	逆作用单压/电动逆作用(DC24V) Reverse acting single pressure/electric reverse acting (DC24V)
4	逆作用双压 Reverse acting double pressure
5	*电动正作用(AC100V) * Electric direct acting (AC100V)
6	*电动逆作用(AC100V) * Electric reverse acting (AC100V)

8 控制器式样 Controller pattern

	磁感应开关 Magnetic sensing switch		内置电磁阀 Built-in electromagnetic valve		
	2个	3个	*1	*2	*3
E	○		○		
F	○			○	
G		○		○	
H		○			○
X	特殊 Special				

9 阀杆形式 Stem form

0	标准 Standard
P	锥面和密封垫圈组装 Taper and sealing gasket assembly
M	锥面一体式阀杆 Taper integral stem

10 标准值 Standard value

000	标准 Standard
-----	-------------

11 接液部材质 Material of liquid-contacting part

	阀体材质 Body material	阀杆材质 Stem material
0	SUS304	SUS316
6	SUS316	SUS316
7	SUS316L	SUS316L
X	特殊 Special	特殊 Special

12 材质 Material

	密封垫圈 Sealing gasket	轴封 Shaft seal	接液部O形圈 O ring of liquid-contacting part
0	EPDM	EPDM	EPDM
H	HNBR	HNBR	HNBR
J	FKM	FKM	Si
X	特殊 Special		

13 表面处理 Surface treatment

	内面 Interior surface	外面 Exterior surface
0	喷砂研磨 Sandblasting abrasive	喷砂研磨 Sandblasting abrasive
1	抛光研磨 polishing	喷砂研磨 polishing
2	电解研磨 Electrolytic grinding	电解研磨 Electrolytic grinding
X	特殊 special	特殊 special

14 洗净样式 Washing pattern

0	L 洗净 Wash
M	M 洗净 Wash
H	H 洗净 Wash



L/T型

D/E/F型

A/B/C型

■ L/T型

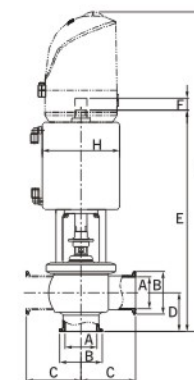

型式 Model	尺寸 Size							
	φA	φB	C	D	E	F	G	H
25	23	50.5	58	40	243	9.5	394	65
38	35.7	50.5	70	49	285	15	436	91
50	47.8	64	82	58	332	18	479.5	116
64	59.5	77.5	105	64	390	21	537.5	137
76	72.3	91	110	70	428	18	575.5	156
100	97.6	119	155	82	628	27.5	775.2	146

■ D/E/F型

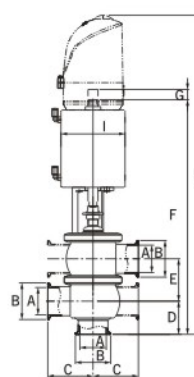

型式 Model	尺寸 Size								
	φA	φB	C	D	E	F	G	H	I
25	23	50.5	58	40	48	289.5	8.5	442	65
38	35.7	50.5	70	49	60	345	12	496	91
50	47.8	64	82	58	74	410	18	557.5	116
64	59.5	77.5	105	64	90	480	18	627.5	137
76	72.3	91	110	70	104	532	18	679.5	156
100	97.6	119	155	82	132	760	24.5	907.2	146

■ A/B/C型

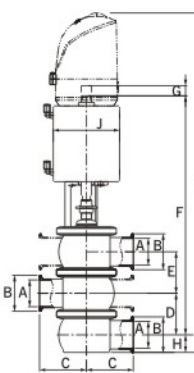

型式 Model	尺寸 Size									
	φA	φB	C	D	E	F	G	H	I	J
25	23	50.5	55	48	48	316	8.5	18.5	469	65
38	35.7	50.5	70	60	60	380.3	12	24.3	531	91
50	47.8	64	82	74	74	453.4	15	31.4	601	116
64	59.5	77.5	105	90	90	544	18	38.2	692	137
76	72.3	91	110	104	104	611	21	45.1	758.6	156
100	97.6	119	155	132	132	867	27.5	57.3	1014.5	146

FLOW CONTROL VALVE

流量调节阀



气缸调节定位规格(DS)

气压马达的3种状态：全开、半开、全闭
通过调节机构可以任意变更阀的开度，
从而控制阀的流量。

Cylinder control positioning specification (DS)

Three states of pneumatic motor: full opening, semi opening, full closing
Valve opening can be changed freely through the control mechanism so as to control the valve flow.

型号 Model

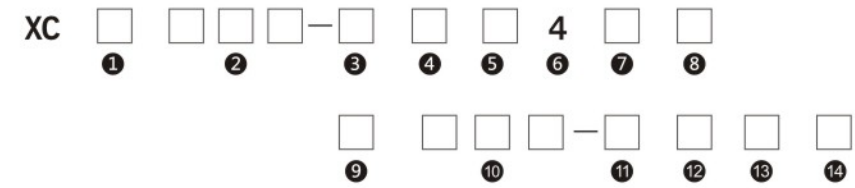

1 接口 Connection

K	管夹 Pipe clamp
N	螺纹 Thread
W	焊接 Welding

2 口径 Size

025	25mm
038	38mm
050	50mm
064	64mm
076	76mm
100	100mm

3 形式 Form

A	自动 Automatic
H	手动 Manual
M	电动 Electric

4 阀体形状 Body shape

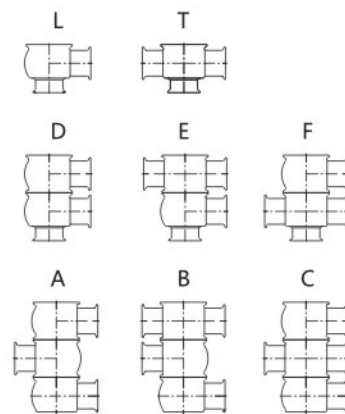

5 轴封式样 Shaft seal pattern

0	标准 (密封圈) Standard (seal ring)
E	无菌 (分割隔膜片) Aseptic (Segmented diaphragm)

6 气缸式样 Cylinder pattern

4	WSP马达 WSP motor
---	-----------------

7 气缸动作 Cylinder action

N	无 No
1	正作用单压/电动正作用(DC24V) Direct acting single pressure/electric direct acting (DC24V)
2	正作用双压 Direct acting double pressure
3	逆作用单压/电动逆作用(DC24V) Reverse acting single pressure/electric reverse acting (DC24V)
4	逆作用双压 Reverse acting double pressure
5	*电动正作用(AC100V) * Electric direct acting (AC100V)
6	*电动逆作用(AC100V) * Electric reverse acting (AC100V)

8 控制器式样 Controller pattern

	磁感应开关 Magnetic sensing switch		内置电磁阀 Built-in electromagnetic valve		
	2个	3个	*1	*2	*3
E	○		○		
F	○			○	
G		○		○	
H		○			○
X	特殊 Special				

9 阀杆形式 Stem form

0	标准 Standard
P	锥面和密封垫圈组装 Taper and sealing gasket assembly
M	锥面一体式阀杆 Taper integral stem

10 标准值 Standard value

000	标准 Standard
-----	-------------

11 接触部材质 Material of liquid-contacting part

	阀体材质 Body material	阀杆材质 Stem material
0	SUS304	SUS316
6	SUS316	SUS316
7	SUS316L	SUS316L
X	特殊 Special	特殊 Special

12 材质 Material

	密封垫圈 Sealing gasket	轴封 Shaft seal	接液部O形圈 O ring of liquid-contacting part
0	EPDM	EPDM	EPDM
H	HNBR	HNBR	HNBR
J	FKM	FKM	Si
X	特殊 Special		

13 表面处理 Surface treatment

	内面 Interior surface	外面 Exterior surface
0	喷砂研磨 Sandblasting abrasive	喷砂研磨 Sandblasting abrasive
1	抛光研磨 polishing	喷砂研磨 polishing
2	电解研磨 Electrolytic grinding	电解研磨 Electrolytic grinding
X	特殊 special	

14 洗净样式 Washing pattern

0	L 洗净 Wash
M	M 洗净 Wash
H	H 洗净 Wash



L/T型

D/E/F型

A/B/C型

■ L/T型

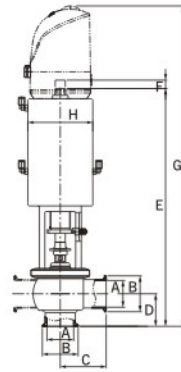

型式 Model	尺寸 Size							
	φA	φB	C	D	E	F	G	H
25	23	50.5	55	40	331.5	9.5	483	65
38	35.7	50.5	70	49	371.5	15	522	91
50	47.8	64	82	58	424.5	18	572	116
64	59.5	77.5	105	64	487	21	634.5	137
76	72.3	91	110	70	532	24	679	156
100	97.6	119	155	82	735.1	27.5	882.6	146

■ D/E/F型

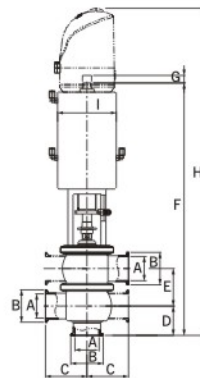

型式 Model	尺寸 Size								
	φA	φB	C	D	E	F	G	H	I
25	23	50.5	55	40	48	378	8.5	531	65
38	35.7	50.5	70	49	60	431.5	12	582	91
50	47.8	64	82	58	74	498.5	15	646	116
64	59.5	77.5	105	64	90	577	18	724.5	137
76	72.3	91	110	70	104	636	21	763	156
100	97.6	119	155	82	132	867	24.5	1014.6	146

■ A/B/C型

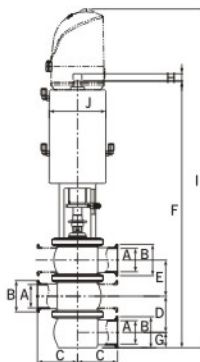

型式 Model	尺寸 Size									
	φA	φB	C	D	E	F	G	H	I	J
25	23	50.5	55	48	48	404.5	18.5	8.5	557	65
38	35.7	50.5	70	60	60	467	24.3	12	618	91
50	47.8	64	82	74	74	545.9	31.4	15	694	116
64	59.5	77.5	105	90	90	641	38.2	18	788.7	137
76	72.3	91	110	104	104	714.6	45.1	21	862	156
100	97.6	119	155	132	132	974	57.3	24.5	1122	146



ASEPTIC SEGMENTED
DIAPHRAGM VALVE

无菌分割隔膜阀

海吉雅无菌阀，阀接液动作部分与外面的驱动部分被铁氟龙隔膜分割开，与外界空气完全隔离，防止制品的污染。维持无菌状态，是重要的杀菌，灭菌工序后的生产过程最适合的产品，被大量的使用。

In the HYGEIA aseptic valve, the liquid-contacting action part and the external driving part are separated by Teflon diaphragm, so as to realize total isolation from the outside air and avoid pollution of the products. Maintaining the aseptic status, it is a widely applied product that is most suitable for the production after the important sterilization process.



无菌分割隔膜阀
Aseptic segmented diaphragm valve

■ 隔膜片 Diaphragm

- 隔膜片材质：PTFE
- 隔膜片耐压：0.4MPa 150°C
- 无菌规格的机体辨别，阀门上部的辨别套「白」正运转，「红」是逆运转。

- Diaphragm material: PTFE
- Diaphragm pressure withstanding: 0.4MPa 150°C
- For aseptic machine identification, if the identification cover at the upper part of the valve is white, it means forward running, and if it is red, it means backward running.

■ 优势 Advantages

- 考虑隔膜片的洗净效果，隔膜片采用无死角设计。
- 相比传统的不锈钢伸缩节，耐冲击性更强、动作频率更高，寿命更长，可以达到100万次。
- 成本相对较低，在食品安全、生物制药等要求越来越高的情况下，市场占有率渐增加，性价比很高。
- Considering its washing effects, the diaphragm adopts dead-corner-free design.
- Compared with traditional stainless steel expansion joints, it has more powerful impact resistance, higher action frequency and a longer service life of up to 1 million times.
- Its cost is relatively low. When food safety and biopharmaceutical requirements are higher and higher, its market share is gradually increasing with very high price-performance ratio.

■ 型号 Model

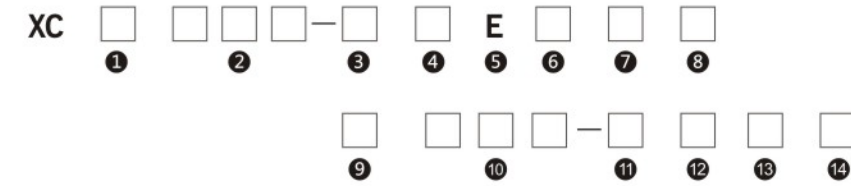

1 接口 Connection

K	管夹 Pipe clamp
N	螺纹 Thread
W	焊接 Welding

2 口径 Size

025	25mm
038	38mm
050	50mm
064	64mm
076	76mm
100	100mm

3 形式 Form

A	自动 Automatic
H	手动 Manual
M	电动 Electric

4 阀体形状 Body shape

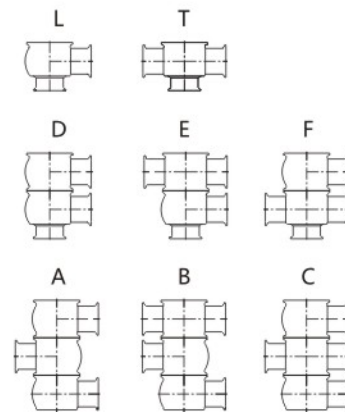

5 轴封式样 Shaft seal pattern

E	无菌（分割隔膜片） Aseptic (Segmented diaphragm)
---	--

6 气缸式样 Drive of the style

N	没有 No
1	标准 standard
4	WSP马达 WSP motor
5	电控控制 Electric control

7 气缸动作 Cylinder action

N	无 No
1	正作用单压/电动正作用(DC24V) Direct acting single pressure/electric direct acting (DC24V)
2	正作用双压 Direct acting double pressure
3	逆作用单压/电动逆作用(DC24V) Reverse acting single pressure/electric reverse acting (DC24V)
4	逆作用双压 Reverse acting double pressure
5	*电动正作用(AC100V) * Electric direct acting (AC100V)
6	*电动逆作用(AC100V) * Electric reverse acting (AC100V)

8 控制器式样 Controller pattern

	磁感应开关 Magnetic sensing switch		内置电磁阀 Built-in electromagnetic valve		
	2个	3个	*1	*2	*3
E	○		○		
F	○			○	
G		○		○	
H		○			○
X	特殊 Special				

9 阀杆形式 Stem form

0	标准 Standard
P	锥面和密封垫圈组装 Taper and sealing gasket assembly
M	锥面一体式阀杆 Taper integral stem

10 标准值 Standard value

000	标准 Standard
-----	-------------

11 接液部材质 Material of liquid-contacting part

	阀体材质 Body material	阀杆材质 Stem material
0	SUS304	SUS316
6	SUS316	SUS316
7	SUS316L	SUS316L
X	特殊 Special	特殊 Special

12 材质 Material

	密封垫圈 Sealing gasket	轴封 Shaft seal	接液部O形圈 O ring of liquid-contacting part
	0	EPDM	EPDM
H	HNBR	HNBR	HNBR
J	FKM	FKM	Si
X	特殊 Special		

13 表面处理 Surface treatment

	内面 Interior surface	外面 Exterior surface
0	喷砂研磨 Sandblasting abrasive	喷砂研磨 Sandblasting abrasive
1	抛光研磨 polishing	喷砂研磨 polishing
2	电解研磨 Electrolytic grinding	电解研磨 Electrolytic grinding
X	特殊 special	特殊 special

14 洗净样式 Washing pattern

0	L 洗净 Wash
M	M 洗净 Wash
H	H 洗净 Wash



L/T型

D/E/F型

A/B/C型

■ L/T型

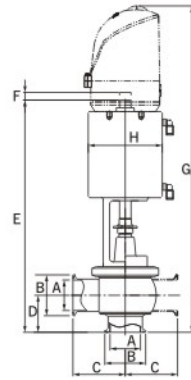

型式 Model	尺寸 Size							
	φA	φB	C	D	E	F	G	H
25	23	50.5	55	40	259	6	411.5	65
38	35.7	50.5	70	40	311.4	10	561.9	91
50	47.8	64	82	58	363.9	12	511.4	116
64	59.5	77.5	105	64	423.8	15	571.3	137
76	72.3	91	110	70	473.2	18	620.7	156
100	97.6	119	155	82	689.8	25	837.4	146

■ D/E/F型

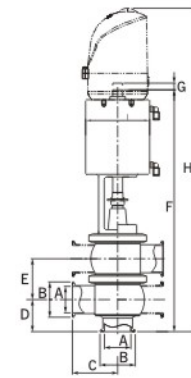

型式 Model	尺寸 Size								
	φA	φB	C	D	E	F	G	H	I
25	23	50.5	55	40	48	307	6	459.5	65
38	35.7	50.5	70	40	60	371.4	10	522	91
50	47.8	64	82	58	74	437.9	12	585.4	116
64	59.5	77.5	105	64	90	513.8	15	661.2	137
76	72.3	91	110	70	104	577.2	18	724.7	156
100	97.6	119	155	82	132	822	24.5	969.4	146

■ A/B/C型

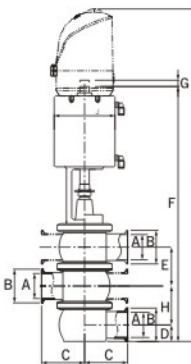

型式 Model	尺寸 Size									
	φA	φB	C	D	E	F	G	H	I	J
25	23	50.5	55	48	48	333.5	6	18.5	486	65
38	35.7	50.5	70	60	60	406.7	10	24.3	557.2	91
50	47.8	64	82	74	74	485.3	12	31.4	632.8	116
64	59.5	77.5	105	90	90	578	15	38.2	725.5	137
76	72.3	91	110	104	104	656.3	18	45.1	803.8	156
100	97.6	119	155	132	132	929	24.5	57.3	1076.7	146

MIXING-PROOF VALVE

防混阀

■ 特征 Features

防混阀是通过压缩空气进行遥控操作的，该阀门于正常情况下是常闭。

该型阀门具有两个独立的阀芯密封件，在正常工作状态时这两个密封件之间就会形成一个与大气相通的泄漏腔，产品就会流进这个泄漏腔，并且从排出口被排放出去。当阀门处于开启状态时，该漏腔是闭合的。因此所输送的产品就能够从一条管线流到另一条去。

该阀门能够对上、下端阀杆以及泄漏腔进行清洗，这有助于使该款阀门达到卫生流体工业处理中所要求的高卫生标准。该阀门的清洗操作更为高效便捷，可以确保原位清洗（CIP）专用流体的直接冲刷能达到所有表面，而且比较常规清洁系统，其所用时间也更短。

The mixing-proof valve is operated remotely through compressed air. The valve is normally closed under normal situations.

This type of valve has two independent plug seals. Under normal working status, a leakage cavity that connects atmosphere will be formed between the two seals. The products will flow into the leakage cavity and be discharged from the outlet. When the valve is under the closing status, the leakage cavity is closed. Therefore, the transported products can flow from one pipeline to another.

The valve can carry out cleaning of the upper and lower stems and leakage cavity, which helps this type of valve to meet high hygiene standards required in sanitary fluid industrial treatment. The more efficient and convenient cleaning operation of the valve can ensure that the direct washing of special CIP fluids can reach all surfaces, and the time spent is shorter when compared with other conventional washing systems.



■ 型号 Model

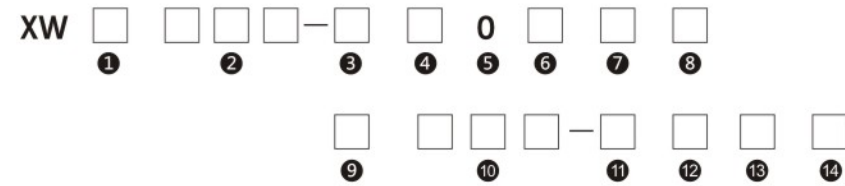

1 接口 Connection

K	管夹 Pipe clamp
W	焊接 Thread

2 口径 Size

038	38mm
050	50mm
064	64mm
076	76mm
100	100mm

3 接口 Form

A	自动 Automatic
---	--------------

4 阀体形状(上部×下部) Body shape

1	T X T
2	L X T
3	T X L
4	L X L90°
5	L X L180°
6	L X L270°

液导管位置 Liquid pipe position

4: L X L90°

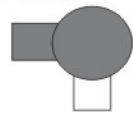

5: L X L180°



6: L X L270°

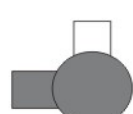

■ 阀体上部 Upper part of the body

5 轴封式样 Shaft seal pattern

0	标准 Standard
C	下部阀体洗净型 Lower stem washing type

6 气缸式样 Cylinder pattern

6	标准 standard
---	-------------

7 气缸动作 Cylinder action

3	逆动作双压 Reverse acting double pressure
---	--------------------------------------

8 控制器式样 Controller pattern

	磁感应开关 Magnetic sensing switch		内置电磁阀 Built-in electromagnetic valve		
	2个	3个	*1	*2	*3
E	○				○
G		○			○

9 阀杆形式 Stem form

0	标准 Standard
---	-------------

10 标准值 Standard value

000	标准 Standard
-----	-------------

11 接液部材质 Material of liquid-contacting part

	阀体材质 Body material	阀杆材质 Stem material
6	SUS316	SUS316

12 材质 Material

	轴密封垫圈 Sealing gasket	轴封 Shaft seal	接液部O形圈 O ring of liquid-contacting part
N	HNBR	EPDM	EPDM
H	HNBR	HNBR	HNBR

13 表面处理 Surface treatment

	内面 Interior surface	外面 Exterior surface
0	喷砂研磨 Sandblasting abrasive	喷砂研磨 Sandblasting abrasive
1	抛光研磨 polishing	喷砂研磨 polishing
2	电解研磨 Electrolytic grinding	电解研磨 Electrolytic grinding

14 洗净样式 Washing pattern

0	L 洗净 Wash
---	-----------



■ L/T型

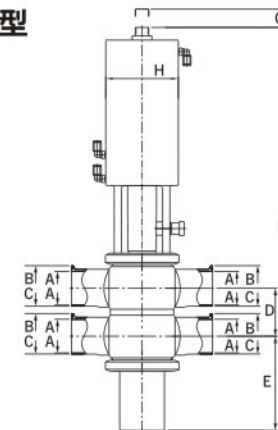

型式 Model	尺寸 Size								
	φA	φB	φC	D	E	F	G	H	I
38	35.7	50.5	38.1	56	127.6	559.7	21.2	707.2	103
50	47.8	64	50.8	68.1	133.7	571.9	26	719.4	103
64	59.5	77.5	63.5	80	162	677	33	824.5	128.5
76	72.3	91	76.3	92.8	168.4	690	33	837.3	128.5
100	97.6	119	101.6	118	182	807.8	43	955.3	158

ELECTRIC FLOW CONTROL VALVE

电动流量调节阀

流量控制最准确的执行机构

控制头采用伺服电机控制，能精密控制阀的流量，性能稳定。

Actuator with the most accurate flow control

The controller is controlled by servo motor to precisely control the valve flow with stable performance.

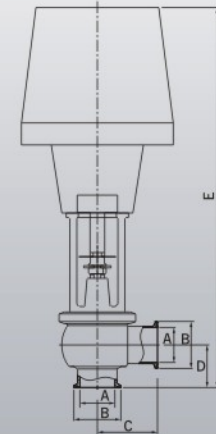

特征

- 不需要空气设备
在没有空气源的房间，只要电子机械设备就可以远距离进行控制。
供给电压：DC24V或者AC100V
电流信号：4~20mA DC
- 稳定性：
使用伺服电机，实现全开全闭0.75MPa(38mm)的推力。阀体内压力的变化不会影响关闭效果。最适合当作背压阀之类的压力控制阀使用。

Features

- No air equipment is needed.
In a room without air supply, just use electronic machinery to realize remote control.
Power voltage: DC24V or AC100V
Current signal: 4~20mA DC
- Stability:
Servo motor is adopted to realize 0.75MPa (38mm) thrust under full opening or full closing status. The change of pressure inside the body will not influence the closing effect. It is most suitable for serving as a pressure control valve of back pressure valves.

型式 Model	尺寸 Size				
	A	B	C	D	E
38	35.7	50.5	70	49	495
50	47.8	64	82	58	518
64	59.5	77.5	105	64	535

型号 Model

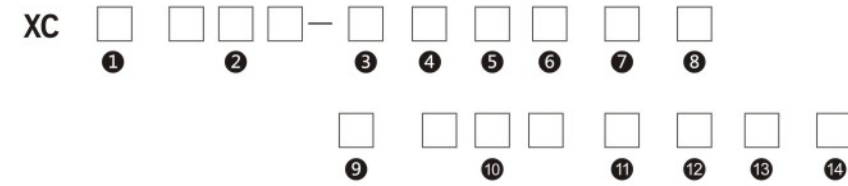

1 接口 Connection	
K	管夹 Pipe clamp
N	螺纹 Thread
W	焊接 Welding

2 口径 Size	
025	25mm
038	38mm
050	50mm
064	64mm
076	76mm
100	100mm

3 形式 Form	
A	自动 Automatic
H	手动 Manual
M	电动 Electric

4 阀体形状 Body shape	
L	L型 L type

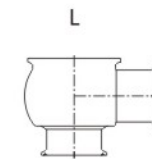

5 轴封式样 Shaft seal pattern	
0	标准 (密封圈) Standard (seal ring)
E	无菌 (分割隔膜片) Aseptic (Segmented diaphragm)

6 气缸式样 Cylinder pattern	
N	没有 No
1	标准 standard
3	SP马达 SP motor
4	WSP马达 WSP motor
5	电控制 Electric control

7 气缸动作 Cylinder action	
N	无 No
1	正作用单压/电动正作用(DC24V) Direct acting single pressure/electric direct acting (DC24V)
2	正作用双压 Direct acting double pressure
3	逆作用单压/电动逆作用(DC24V) Reverse acting single pressure/electric reverse acting (DC24V)
4	逆作用双压 Reverse acting double pressure
5	*电动正作用(AC100V) * Electric direct acting (AC100V)
6	*电动逆作用(AC100V) * Electric reverse acting (AC100V)

8 控制器式样 Controller pattern				
	磁感应开关 Magnetic sensing switch		内置电磁阀 Built-in electromagnetic valve	
	2个	3个	*1	*2 *3
0				

9 阀杆形式 Stem form	
0	标准 Standard
P	锥面和密封垫圈组装 Taper and sealing gasket assembly
M	锥面一体式阀杆 Taper integral stem

10 标准值 Standard value	
000	标准 Standard

11 接液部材质 Material of liquid-contacting part		
	阀体材质 Body material	阀杆材质 Stem material
0	SUS304	SUS316
6	SUS316	SUS316
7	SUS316L	SUS316L
X	特殊 Special	特殊 Special

12 材质 Material			
	密封垫圈 Sealing gasket	轴封 Shaft seal	接液部O形圈 O ring of liquid-contacting part
N	NO	EPDM	EPDM

13 表面处理 Surface treatment		
	内面 Interior surface	外面 Exterior surface
0	喷砂研磨 Sandblasting abrasive	喷砂研磨 Sandblasting abrasive
1	抛光研磨 polishing	喷砂研磨 polishing
2	电解研磨 Electrolytic grinding	电解研磨 Electrolytic grinding
X	特殊 special	特殊 special

14 洗净样式 Washing pattern	
0	L 洗净 Wash
M	M 洗净 Wash
H	H 洗净 Wash

MANUAL VALVE

手动阀

海吉雅手动阀，是轻量并且构造简单的手动阀。使用操作简单，适用于各种场所。重视卫生性，结构坚固，保养维修也非常容易。

The HYGEIA manual valve is a valve with light weight and simple construction. With simple use and operation, it is suitable for various applications. Focused on hygiene, it has solid structure and it is very easy to maintain and service.



■ 特征 Features

- 简单独特的构造分解，检查容易。
- 各项零件通用，可以有多种多样的组装方式。
- 利用手动停止器可以简单的调节开闭程度。
- 阀桿垫圈的交换使用专用工具，可以简单的进行交换。

- Simple and unique construction, easy disassembly for inspection
- All parts are interchangeable. There are diversified assembly ways.
- Manual stopper can be adopted to carry out simple adjustment of the opening or closing degree.
- The stem gaskets are replaced by using special tools. Simple replacement can be carried out.

■ 型号 Model

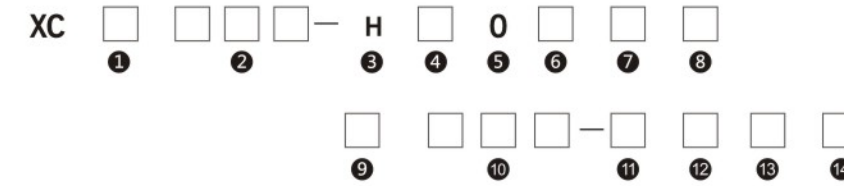

① 接口 Connection	
K	管夹 Pipe clamp
N	螺纹 Thread
W	焊接 Welding

② 口径 Size	
025	25mm
038	38mm
050	50mm
064	64mm
076	76mm
100	100mm

③ 形式 Form	
H	手动 Manual

④ 阀体形状 Body shape

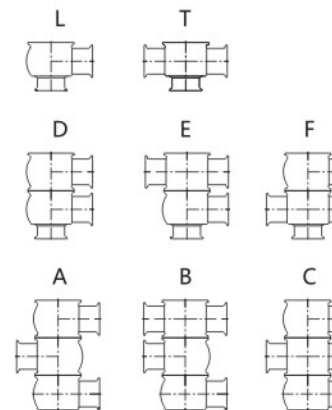

⑤ 轴封式样 Shaft seal pattern	
0	标准 (密封圈) Standard (seal ring)
E	无菌 (分割隔膜片) Aseptic (Segmented diaphragm)

⑥ 气缸式样 Cylinder pattern	
N	没有 No
1	标准 standard
4	WSP马达 WSP motor
5	电控控制 Electric control

⑦ 气缸动作 Cylinder action	
N	无 No
1	正作用单压/电动正作用(DC24V) Direct acting single pressure/electric direct acting (DC24V)
2	正作用双压 Direct acting double pressure
3	逆作用单压/电动逆作用(DC24V) Reverse acting single pressure/electric reverse acting (DC24V)
4	逆作用双压 Reverse acting double pressure
5	*电动正作用(AC100V) * Electric direct acting (AC100V)
6	*电动逆作用(AC100V) * Electric reverse acting (AC100V)

⑧ 控制器式样 Controller pattern					
	磁感应开关 Magnetic sensing switch		内置电磁阀 Built-in electromagnetic valve		
	2个	3个	*1	*2	*3
O					
E	○		○		
F	○			○	
G		○		○	
H		○			○
X	特殊 Special				

⑨ 阀杆形式 Stem form	
0	标准 Standard
P	锥面和密封垫圈组装 Taper and sealing gasket assembly
M	锥面一体式阀杆 Taper integral stem

⑩ 标准值 Standard value	
000	标准 Standard

⑪ 接液部材质 Material of liquid-contacting part		
	阀体材质 Body material	阀杆材质 Stem material
0	SUS304	SUS316
6	SUS316	SUS316
7	SUS316L	SUS316L
X	特殊 Special	特殊 Special

⑫ 材质 Material			
	密封垫圈 Sealing gasket	轴封 Shaft seal	接液部O形圈 O ring of liquid-contacting part
0	EPDM	EPDM	EPDM
H	HNBR	HNBR	HNBR
J	FKM	FKM	Si
X	特殊 Special		

⑬ 表面处理 Surface treatment		
	内面 Interior surface	外面 Exterior surface
0	喷砂研磨 Sandblasting abrasive	喷砂研磨 Sandblasting abrasive
1	抛光研磨 polishing	喷砂研磨 polishing
2	电解研磨 Electrolytic grinding	电解研磨 Electrolytic grinding
X	特殊 special	特殊 special

⑭ 洗净样式 Washing pattern	
0	L 洗净 Wash
M	M 洗净 Wash
H	H 洗净 Wash



L/T型

D/E/F型

A/B/C型

■ L/T型

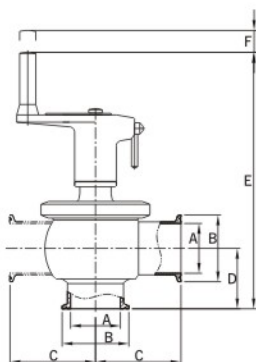

型式 Model	尺寸 Size					
	φ A	φ B	C	D	E	F
25	23	50.5	58	40	181.5	9.5
38	35.7	50.5	70	49	196	12
50	47.8	64	82	58	246	18
64	59.5	77.5	105	64	259	21
76	72.3	91	110	70	271	24
100	97.6	119	155	82	320	27.5

■ D/E/F型

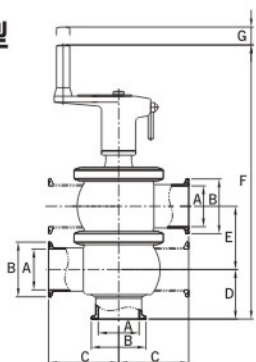

型式 Model	尺寸 Size						
	φ A	φ B	C	D	E	F	G
25	23	50.5	55	40	48	229.5	8.5
38	35.7	50.5	70	49	60	256	12
50	47.8	64	82	58	74	320	15
64	59.5	77.5	105	64	90	349	18
76	72.3	91	110	70	104	375	21
100	97.6	119	155	82	132	452	24.5

■ A/B/C型

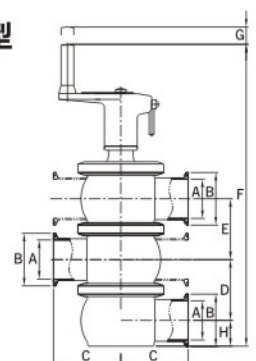

型式 Model	尺寸 Size							
	φ A	φ B	C	D	E	F	G	H
25	23	50.5	55	48	48	256	8.5	18.5
38	35.7	50.5	70	60	60	291	12	24.3
50	47.8	64	82	74	74	367.4	18	31.4
64	59.5	77.5	105	90	90	414	18	38
76	72.3	91	110	104	104	454	18	45
100	97.6	119	155	132	132	559	24.5	54.3

CHECK VALVE

单向阀

精确的开闭压力，很小的压力损耗。独特的设计，阀芯采用滑动配合，使阀密封更具有稳定性和持久性。阀芯材料的特殊加工工艺，使模芯导向部分更具有耐磨性。

It has precise opening pressure and closing pressure with very low pressure loss. With unique design, the plug adopts sliding fit, making the valve sealing more stable and lasting. The plug is subject to special machining process, so that the guiding part becomes more wear resistant.



■ 型号 Model

XK K □ □ □ - 0 □ □ □ - □ □ □
 ① ② ③ ④ ⑤ ⑥ ⑦

1 接口 Connection

K	管夹 Pipe clamp
---	---------------

2 口径 Size

025	25mm
038	38mm
050	50mm
064	64mm
076	76mm
100	100mm

3 阀体形状 Body shape

0	标准 Standard
---	-------------

4 单向阀压力 Check valve pressure

005	口径25、38、50、64、76密封垫圈的材料是EPDM、NBR,不包含100口径 The materials of seal rings for valves of sizes 25, 38, 50, 64 and 76 are EPDM and NBR, not including valves of size 100.
020	口径25、38、50、64、76、100密封垫圈的材料是PTFE The material of seal rings for valves of sizes 25, 38, 50, 64, 76 and 100 is PTFE.

5 接液部材质 Material of liquid-contacting part

	本体、阀杆、阀杆螺丝 Body, stem, stem screw	导向板 Guide plate	导向杆 Guide rod	弹簧 Spring
0	SUS304	SUS304+SUS630	SUS630	SUS316-WPA
6	SUS316	SUS316+SUS630	SUS630	SUS316-WPA

6 材质 Material

	密封垫圈 Sealing gasket	O形圈 O-ring
0	EPDM	EPDM
F	PTFE	Si
N	NBR	HNBR
L	EPDM	HNBR
Q	PTFE	HNBR

7 表面处理 Surface treatment

	内面 Interior surface	外面 Exterior surface
2	400研磨+电解研磨 400 grinding + electrolysis grinding	喷砂研磨+电解研磨 Sand blasting and grinding + electrolysis grinding

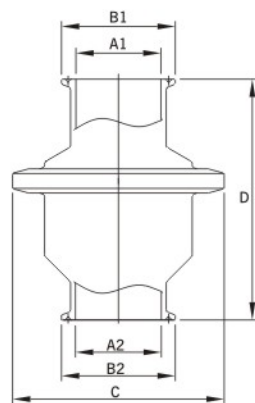

尺寸 Size

型式 Model	φ A1	φ A2	φ B1	φ B2	C	D
25	23	23.5	50.5	50.5	76.4	140
38	35.7	36.2	50.5	50.5	104	134
50	47.8	48.3	64	64	119	135
64	59.5	60	77.5	77.5	133	140
76	72.3	73.5	91	91	175	160
100	97.6	97.7	119	119	175	215

SANITARY PIPE FITTINGS

卫生级配管部件



卡箍
Clamp

接头
Connector

接头密封垫圈
Connector sealing gasket

■ 卡箍
Clamp

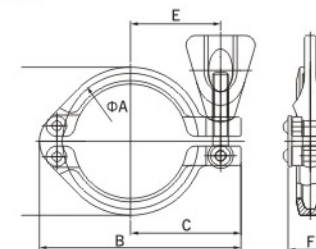

尺寸 Size

型式 Model	A	B	C	D	E	F
1.5"	50.5	90	50	62.4	39.5	19
2"	64	104	57	76.4	46.5	19
2.5"	77.5	119.5	65.5	91	55	19
3"	91	134	72	104	61.5	19
3.5"	106	150.5	79.5	119	69	19
4"	119	164	86.5	139	76.5	19
5.5"	155	201.5	107.5	175	97.5	22

■ 接头
Connector

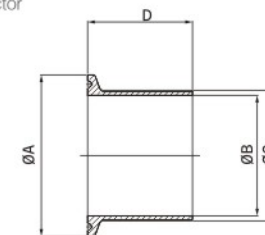

尺寸 Size

型式 Model	A	B	C	D
1"	50.5	23	25.4	21.0
1.5"	50.5	35.7	38.1	21.0
2"	64.0	47.8	50.8	21.0
2.5"	77.5	59.5	63.5	21.0
3"	91.0	72.3	76.3	21.0
4"	119.0	97.6	101.6	21.0

■ 接头密封垫圈
Connector sealing gasket

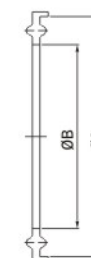

尺寸 Size

型式 Model	A	B
1.0"	50.5	22.8
1.5"	50.5	35.8
2.0"	64.0	48.8
2.5"	77.5	60.5
3.0"	91.0	73.1
4.0"	119.0	97.8

我们可以根据客户的特殊需求量身定制所需要的产品，
我们的产品安全可靠，辅以高附加值服务。

We can customize products according to special requirements of customers.
We provide safe and reliable products in addition to high value-added service.

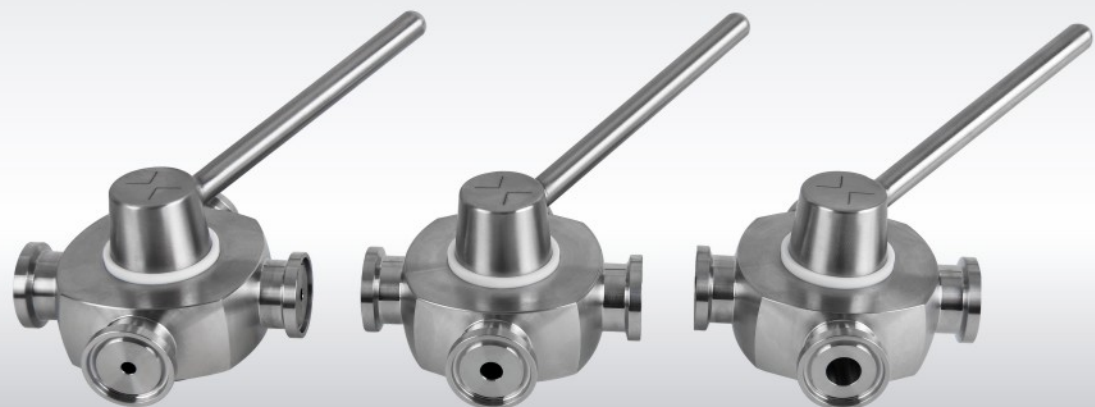

医药用四通阀
Four-way valve for medical use



流量调节换向阀
Flow control reversing valve



无菌取样阀
Aseptic sampling valve